

INDEX OF SMALL TRACTS

- SECTION 32, T16 S,R22 E,S2M.
- 1. ARBITRARY SUBDIVISION
- SECTION 33, T16 S,R22 E,S2M.
- 1. WEST MAIN CANAL SUBDIVISION
- 1. YUMA COUNTY HOME SOCIETY
- SECTION 19, T8 S,R23 W,G& S,R.H.
- 1. ARBITRARY SUBDIVISION
- 2. ARBITRARY SUBDIVISION
- 3. ARBITRARY SUBDIVISION
- 4. ARBITRARY SUBDIVISION
- 5. ARBITRARY SUBDIVISION
- 6. ARBITRARY SUBDIVISION
- 7. ARBITRARY SUBDIVISION
- 8. ARBITRARY SUBDIVISION
- 9. ARBITRARY SUBDIVISION
- 10. DIVIDED SUBDIVISION
- 11. DIVIDED SUBDIVISION
- SECTION 20, T8 S,R23 W,G& S,R.H.
- 1. PARK VIEW SUBDIVISION
- 2. PULDER SUBDIVISION
- 3. VINE SUBDIVISION
- 4. ARBITRARY SUBDIVISION
- 5. ARBITRARY SUBDIVISION
- 6. PLACER SUBDIVISION, UNIT 2
- 7. TUNA BEACH HOLDINGS
- 8. HANCO SUBDIVISION
- 9. MELTOWN SUBDIVISION, UNIT 2
- 10. ARBITRARY SUBDIVISION
- 11. PART OF ARBITRARY UNIT 2
- SECTION 29, T8 S,R23 W,G& S,R.H.
- 1. ARBITRARY SUBDIVISION
- 2. ARBITRARY SUBDIVISION
- 3. ARBITRARY SUBDIVISION
- SECTION 30, T8 S,R23 W,G& S,R.H.
- 1. ARBITRARY SUBDIVISION
- 2. ARBITRARY SUBDIVISION
- SECTION 32, T8 S,R23 W,G& S,R.H.
- 1. ELYSTER ESTATE
- 2. ARBITRARY SUBDIVISION
- SECTION 23, T8 S,R24 W,G& S,R.H.
- 1. ARBITRARY SUBDIVISION
- 2. ARBITRARY SUBDIVISION
- 3. ARBITRARY SUBDIVISION
- SECTION 24, T8 S,R24 W,G& S,R.H.
- 1. ARBITRARY SUBDIVISION
- 2. 5TH VALLEY ESTATES 20
- SECTION 25, T8 S,R24 W,G& S,R.H.
- 1. ARBITRARY SUBDIVISION
- 2. ARBITRARY SUBDIVISION
- 3. WEST HANCO SUBDIVISION, UNIT 2
- 4. CHASE FORD, TRACT 12
- 5. HANCO SUBDIVISION
- 6. UNDEVELOPED ESTATE, UNIT 1
- 7. UNDEVELOPED ESTATE, UNIT 1
- 8. UNDEVELOPED ESTATE, UNIT 1
- 9. PART OF ARBITRARY UNIT 2
- SECTION 26, T8 S,R24 W,G& S,R.H.
- 1. ARBITRARY SUBDIVISION
- 2. 5TH VALLEY ESTATES 20
- SECTION 5, T9 S,R23 W,G& S,R.H.
- 1. ARBITRARY SUBDIVISION
- 2. ARBITRARY SUBDIVISION
- 3. ARBITRARY SUBDIVISION
- 4. ARBITRARY SUBDIVISION
- 5. CONCHO HOME SUBDIVISION
- SECTION 17, T9 S,R23 W,G& S,R.H.
- 1. ARBITRARY SUBDIVISION
- SECTION 18, T9 S,R23 W,G& S,R.H.
- 1. ARBITRARY SUBDIVISION
- SECTION 1, T9 S,R24 W,G& S,R.H.
- 1. ARBITRARY SUBDIVISION
- SECTION 3, T9 S,R24 W,G& S,R.H.
- 1. ARBITRARY SUBDIVISION
- SECTION 10, T9 S,R24 W,G& S,R.H.
- 1. ARBITRARY SUBDIVISION
- 2. ARBITRARY SUBDIVISION
- 3. ARBITRARY SUBDIVISION
- 4. ARBITRARY SUBDIVISION
- 5. SHARON ESTATE, UNIT 2
- SECTION 15, T9 S,R24 W,G& S,R.H.
- 1. ARBITRARY SUBDIVISION
- 2. ARBITRARY SUBDIVISION
- 3. ARBITRARY SUBDIVISION
- SECTION 22, T9 S,R24 W,G& S,R.H.
- 1. ARBITRARY SUBDIVISION
- 2. ARBITRARY SUBDIVISION
- 3. ARBITRARY SUBDIVISION

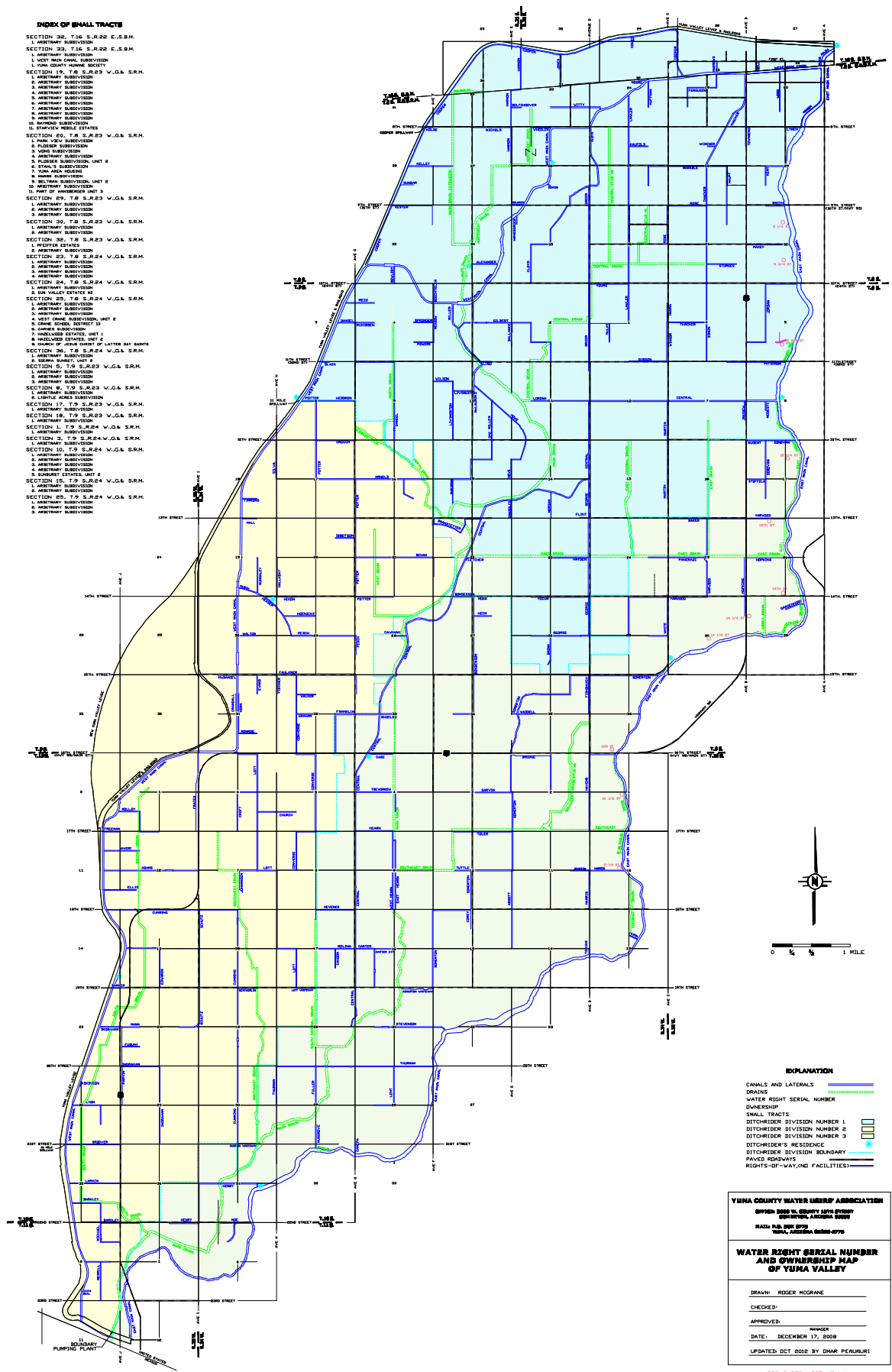

EXPLANATION

- CANALS AND LATERALS
- DITCHES
- WATER RIGHT SERIAL NUMBER
- DITCHRIDER
- SMALL TRACTS
- DITCHRIDER DIVISION NUMBER 1
- DITCHRIDER DIVISION NUMBER 2
- DITCHRIDER DIVISION NUMBER 3
- DITCHRIDER'S RESIDENCE
- DITCHRIDER DIVISION BOUNDARY
- PAVED ROADWAYS
- RIGHTS-OF-WAY (AND FACILITIES)

YUMA COUNTY WATER USERS' ASSOCIATION
 OFFICE: 1000 W. COUNTY 24TH STREET
 CHANDLER, ARIZONA 85226
 MAIL P.O. BOX 6770
 YUMA, ARIZONA 85308-0770

WATER RIGHT SERIAL NUMBER AND OWNERSHIP MAP OF YUMA VALLEY

DRAWN: RIDGER MCGRAW
 CHECKED: _____
 APPROVED: _____
 DATE: DECEMBER 17, 2008
 UPDATED OCT 2018 BY DHAN PEJOURI

FOR INFORMATION ONLY.
 NO LIABILITY ASSUMED.